



**SN0125CS**  
Satin finish

### General description

- Floor-standing WC pan, made of bacteriostatic 304 stainless steel, 1.5mm thick, satin finish.
- Elegant and simple design.
- One-piece pressed WC bowl, seam-free for easy maintenance and better hygiene.
- WC bowl surface is polished with rounded edges for easy cleaning.
- Concealed perimetral flushing rim.
- Horizontal water inlet:  $\varnothing$  55mm.
- Horizontal or vertical waste outlet:  $\varnothing$  100mm. **Supplied with PVC pipe.**
- Water saving: works with 4L or more of water.
- Pre-drilled holes for fixing the toilet seat. Supplied with stainless steel blanking caps when installed without toilet seat lid.
- Quick and easy to install: 2 access panels with theft prevention TORX security screws.
- CE marked. **Complies with European standard EN 997 for 4L flush.**

### Components and materials

- **BOWL:** made of AISI 304 stainless steel, 1.5 mm thick, polished and designed with rounded edges to facilitate waste removal and cleaning.
- **BODY:** made of AISI 304 stainless steel, 1.5 mm thick and anti-vandalism finishes. No sharp edges, corners, or surface welds that prevent accidental user injury. It has two registration doors for installation and maintenance.
- **WATER OUTLET:** horizontal  $\varnothing$ 100 mm. with the possibility of horizontal or vertical connection (PVC adapter supplied).
- **WATER INLET:**  $\varnothing$ 55 mm.

### Technical specifications

<b>Max. dimensions</b>	360 x 580 x 400 mm
<b>Thickness</b>	1.5 mm
<b>Outlet</b>	$\varnothing$ 100 mm
<b>Inlet</b>	$\varnothing$ 55 mm
<b>Net weight</b>	15 Kg

### Dimensions

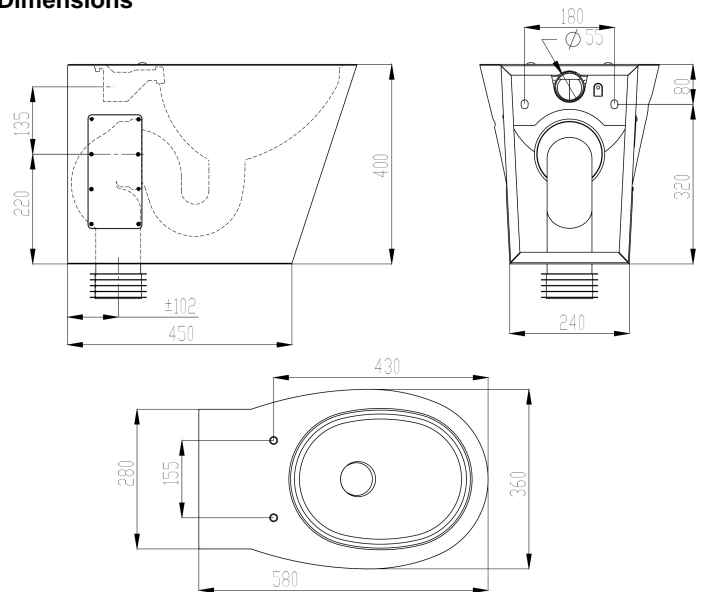

Dimensions:  $\pm$  4%